



# V A L V E S

## WVS Mono-Block Directional Control Valves



### FEATURES:

- 1-6 spool mono-block
- 4000 PSI rating
- #8 SAE O-ring in/out Ports
- #8 SAE O-ring work ports
- Interchangeable motor spool
- Load check
- Parallel cylinder spools
- Adjustable relief
- Enclosed handle design
- Open center – field convertible to power beyond & closed center not included
- Low spool leakage (3cc/min @ 1500 PSI)
- Nominal Flow 14 GPM

## WVS Mono-Block Directional Control Valve Assemblies

VALVE MODEL NO.	NO. OF SPOOLS	SPOOL TYPE, ACTION	WEIGHT (POUNDS)	LIST PRICE
WVS11B5C1	1	4 WAY 3 POSITION, SPRING CENTER TO NEUTRAL, ALL SPOOLS	6.2	259.00
WVS11C5C1	1	4 WAY 3 POSITION MOTOR, 3 POSITION DETENT, ALL SPOOLS	6.5	308.00
WVS21BB5C1	2	4 WAY 3 POSITION, SPRING CENTER TO NEUTRAL, ALL SPOOLS	9.9	458.00
WVS31BBB5C1	3	4 WAY 3 POSITION, SPRING CENTER TO NEUTRAL, ALL SPOOLS	13.9	569.00
WVS41BBB5C1	4	4 WAY 3 POSITION, SPRING CENTER TO NEUTRAL, ALL SPOOLS	17.6	719.00
WVS51BBBB5C1	5	4 WAY 3 POSITION, SPRING CENTER TO NEUTRAL, ALL SPOOLS	21.3	842.00
WVS61BBBB5C1	6	4 WAY 3 POSITION, SPRING CENTER TO NEUTRAL, ALL SPOOLS	25.1	996.00

## WVS Directional Control Valve Parts

PART NO.	DESCRIPTION	LIST PRICE
612104080	DOUBLE ACTING SPOOL	53.00
612104081	MOTOR SPOOL	53.00
612104082	FLOAT SPOOL PLUS DETENT POSITIONER (CAN BE USED ON ANY SPOOL LOCATION)	132.00
660170066	HANDLE WITH KNOB	14.00
660170067	JOYSTICK HANDLE WITH KNOB	53.00
660170068	3 POSITION DETENT KIT (DETENT IN POSITION 1, 0, AND 2)	84.00
660370002	POWER BEYOND PLUG / CLOSED CENTER PLUG	40.00
660370003	HANDLE HOUSING	40.00
660370004	JOYSTICK KIT (FIELD INSTALLABLE) (HANDLE INCLUDED)	229.00
660570005	SEAL KIT (COMPLETE FOR UP TO 6 SECTIONS INCLUDING OR SEAL FOR MAIL RELIEF VALVE)	60.00



# V A L V E S

## Model WVS Specifications and Dimensional Data

MAXIMUM OPERATING PRESSURE 4000 PSI  
 MAXIMUM TANK PRESSURE 300 PSI  
 NOMINAL FLOW RATING 14 GPM  
 MAXIMUM OPERATING TEMPERATURE 180° F

STRAIGHT HANDLE LENGTH: 7.1 INCHES  
 FILTRATION RECOMMENDATIONS: ISO 4406 19 / 17 / 14  
 SPOOL SEALS IN INTERNAL O-RING GROOVES  
 HIGH PRESSURE ADJUSTABLE RELIEF ADJUSTMENT RANGE  
 2200-3200 PSI (PRESET TO 2500 PSI)

NOTE: WITH POWER BEYOND SLEEVE INSTALLED THE TOP OUTLET PORT BECOMES POWER BEYOND PORT AND OUTLET PORT IS LOCATED HERE.

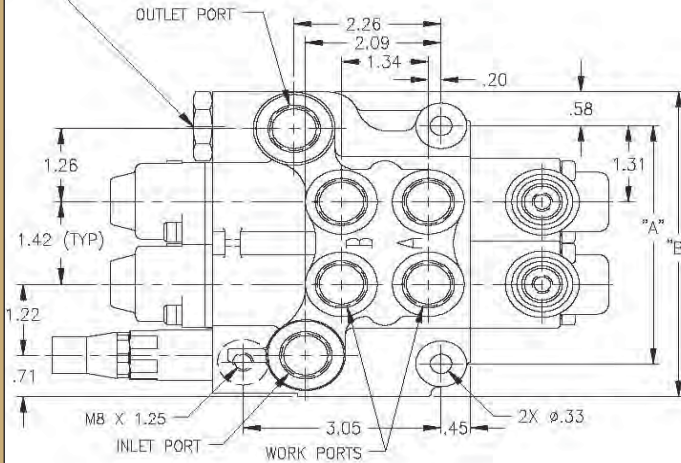

ALL DIMENSIONS ARE FOR REFERENCE ONLY:

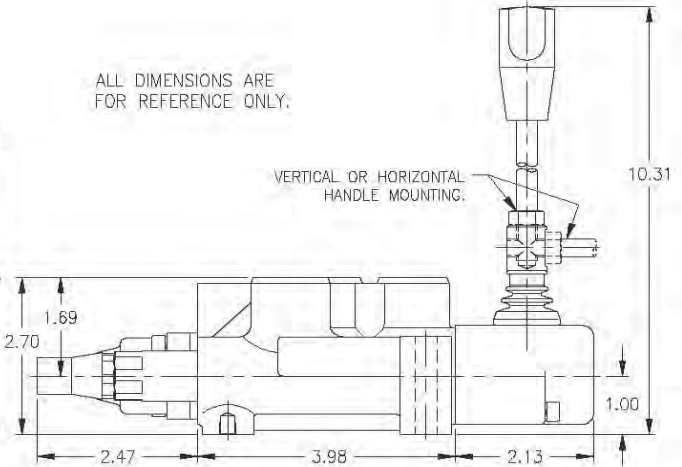

INLET & OUTLET PORTS: #8 SAE/ORB (3/4-16UNF-2B)  
 ALL WORK PORTS: #8 SAE/ORB (3/4-16UNF-2B)  
 OPTIONAL POWER BEYOND SLEEVE: #8 SAE/ORB (3/4-16UNF-2B)

NUMBER OF SPOOLS:

	1	2	3	4	5	6
"A"	2.68	4.09	5.51	6.93	8.35	9.76
"B"	3.82	5.24	6.65	8.07	9.49	10.91

## Performance Curves

