

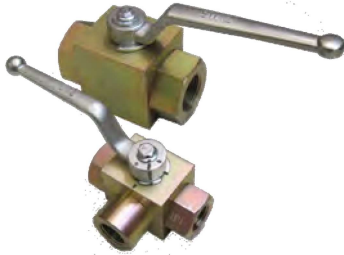

# V A L V E S

## Ball Valves for Hydraulic Use



### FEATURES:

- 1/4", 3/8", 1/2" sizes 7,250 PSI (CWP)
- Carbon Steel Body Zinc Plated
- Hard Chrome Plated Steel Ball, POM Seat
- 3 way valves are "L" Type
- Operating Temp -20° to 175° F
- Not Recommended for Steam, Gas, or Water Service

## 2 Way High Pressure Ball Valves

MODEL No.	PORT SIZE	MAX PSI	SHIPPING WEIGHT	LIST PRICE
WBV2-400	1/4" NPTF	7,250 PSI	1.0	34.00
WBV2-600	3/8" NPTF	7,250 PSI	1.5	38.00
WBV2-800	1/2" NPTF	7,250 PSI	2.0	45.00
WBV2-SAE6	SAE6	7,250 PSI	1.5	38.00
WBV2-SAE8	SAE8	7,250 PSI	2.0	45.00

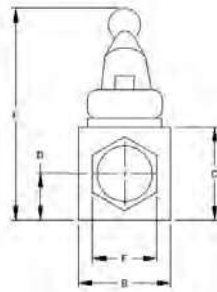
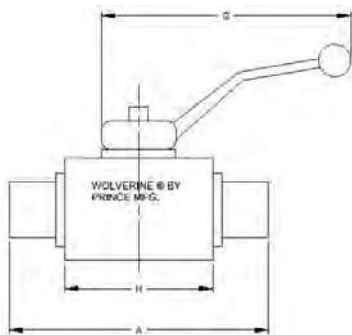

MODEL NO.	A	B	C	D	E	F	G	H
WBV2-400	2.72	1.02	1.30	.53	2.83	.86	4.31	1.57
WBV2-600	2.83	1.25	1.42	.63	2.87	1.06	4.72	1.65
WBV2-800	3.27	1.38	1.50	.70	2.95	1.18	4.72	1.65
WBV2-SAE6	2.83	1.25	1.42	.63	2.87	1.06	4.72	1.65
WBV2-SAE8	3.27	1.38	1.50	.70	2.95	1.18	4.72	1.85

## 3 Way High Pressure Ball Valves (L-Bore)

WBV3L-600	3/8" NPTF	7,250 PSI	2.0	Call
WBV3L-800	1/2" NPTF	7,250 PSI	2.5	Call

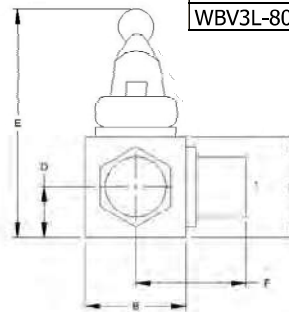
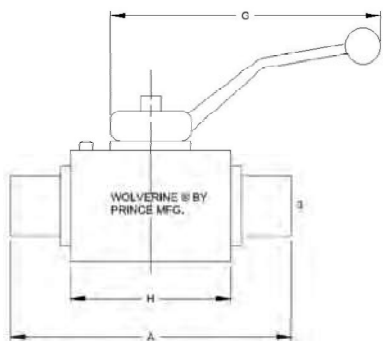

MODEL NO.	A	B	C	D	E	F	G	H
WBV3L-600	2.83	1.25	1.42	.63	2.87	2.05	4.72	1.65
WBV3L-800	3.27	1.38	1.50	.70	2.95	2.26	4.72	1.85